

Option 1: 4 Tables, 48-56 people

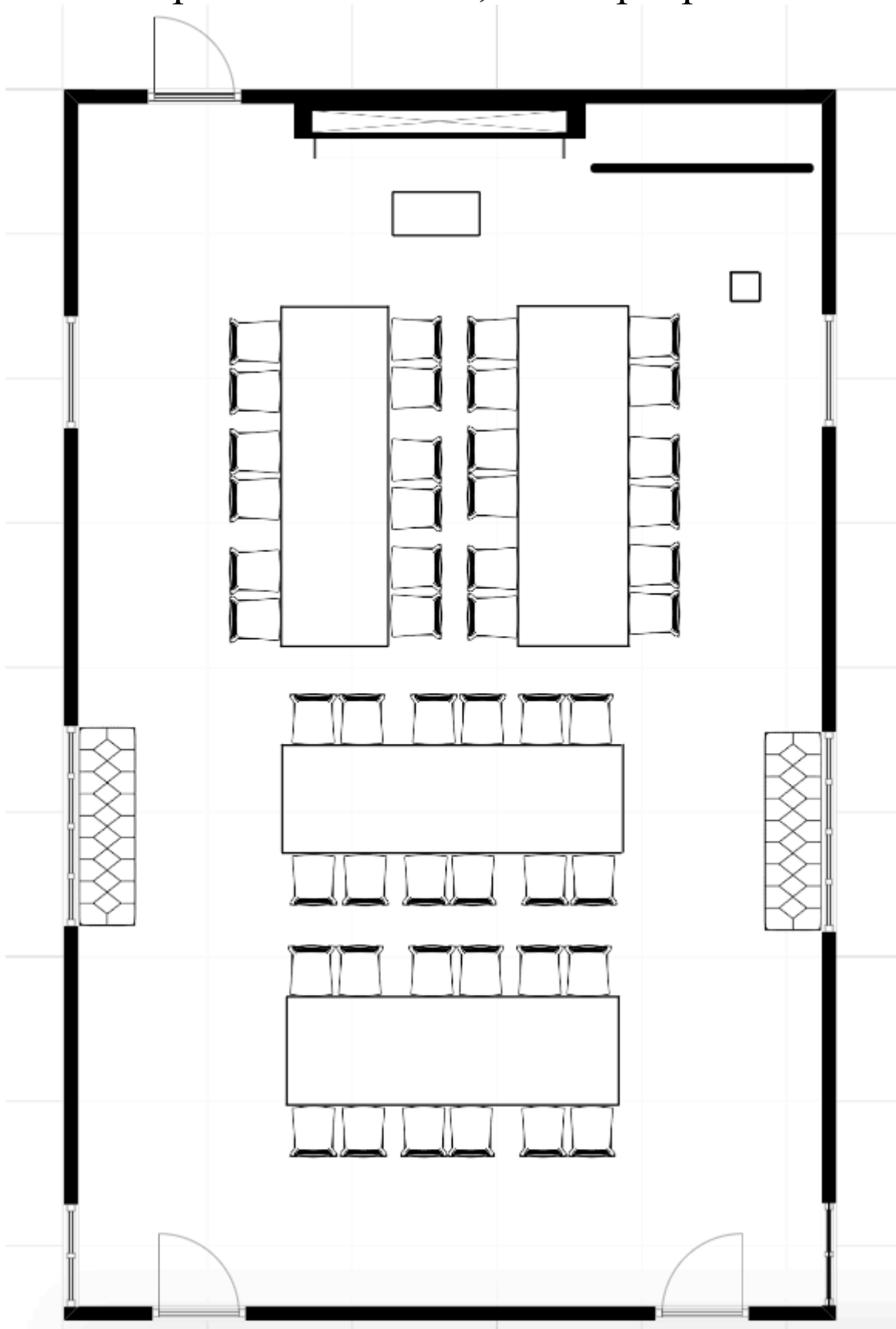

Option 2: Auditorium, 60-80 people

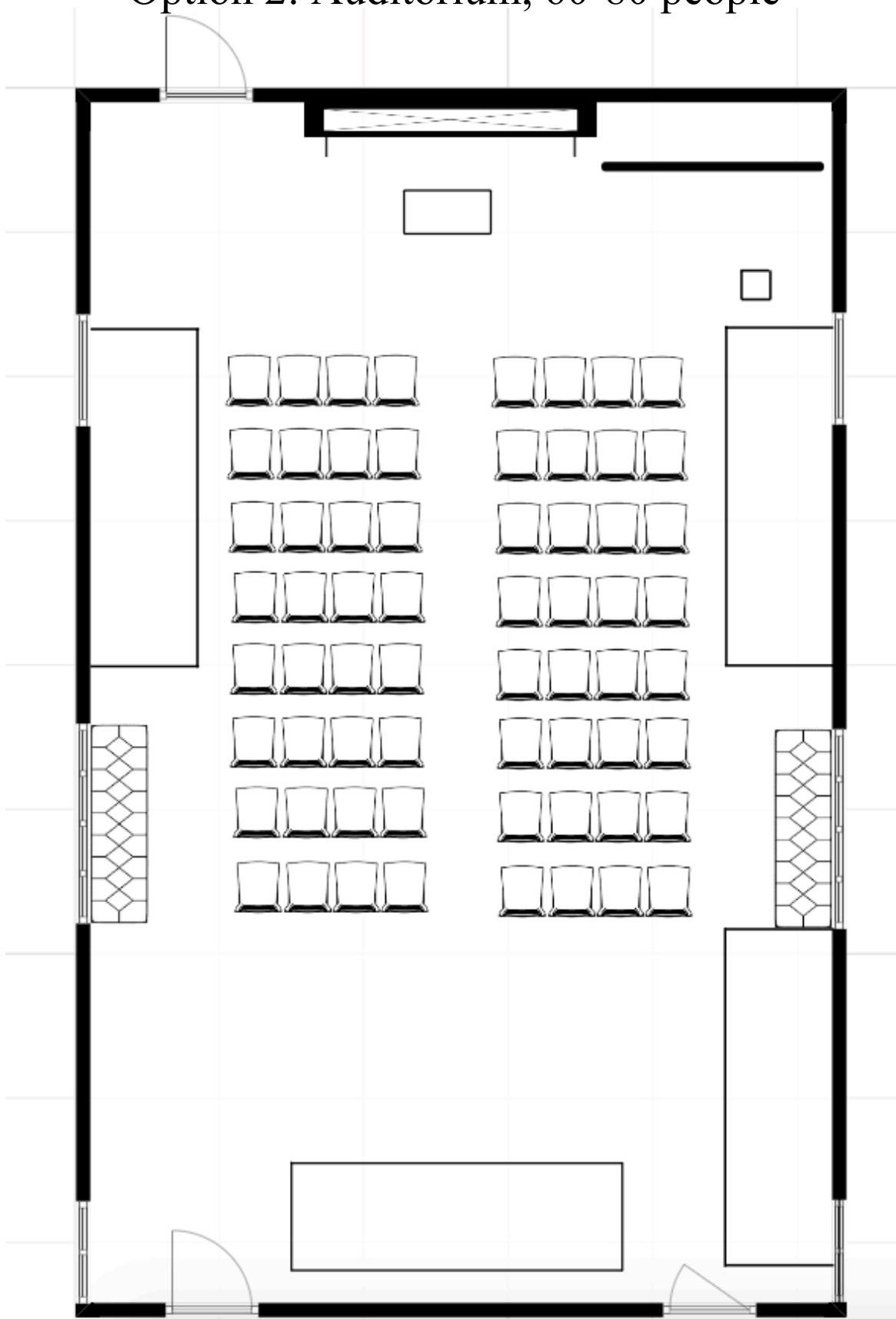

This floor plan shows a large conference room. The central feature is a U-shaped table with 24 chairs: 12 on the left, 12 on the right, and 6 at the bottom. At the top of the room is a stage area with a large screen and a podium. Two sideboards with diamond-patterned fronts are located on the left and right walls. The room has a grid floor and a thick black border representing the walls.

Option 4: Tables in a Square, 20-28 people

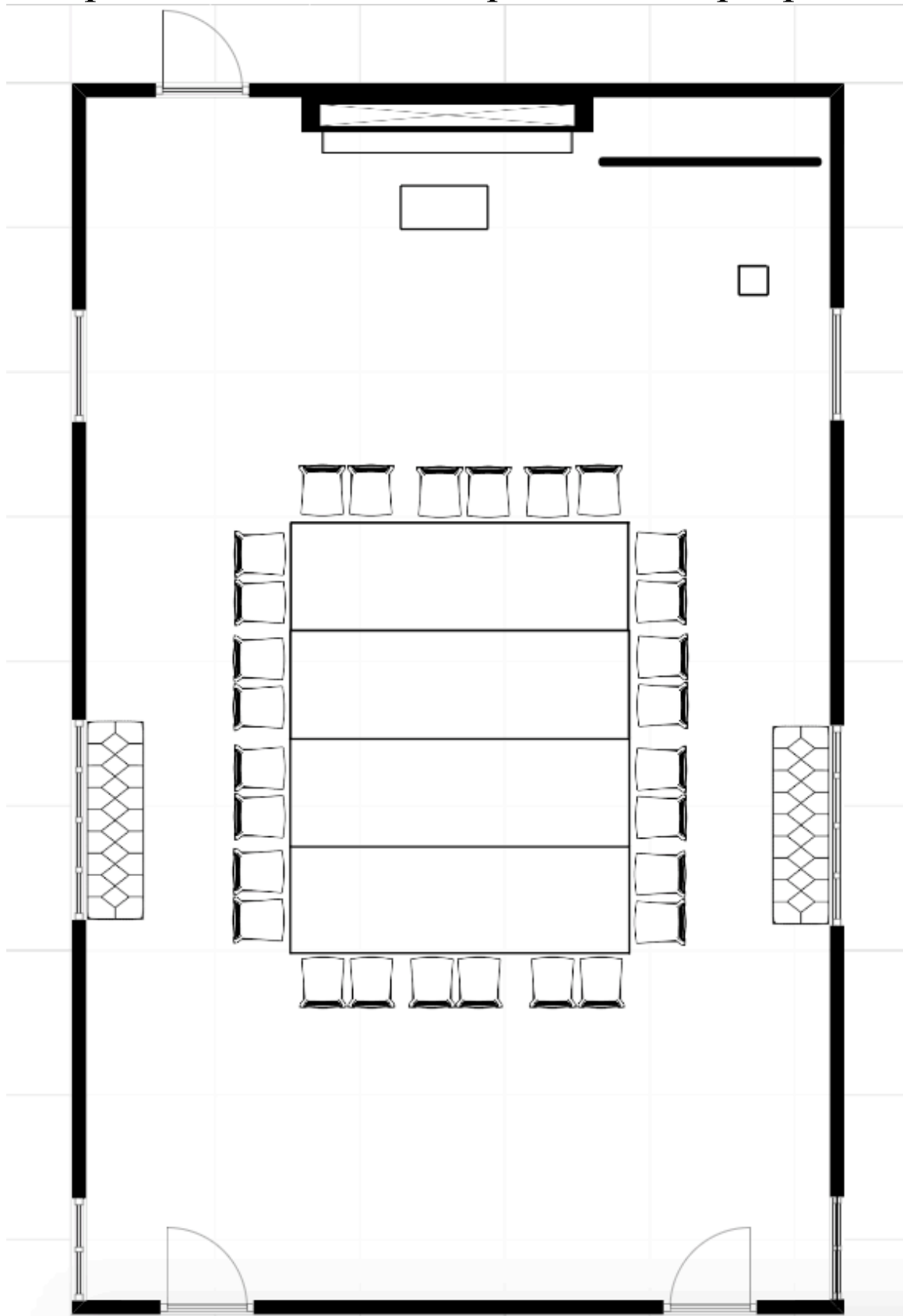

Option 5: Chairs in a Circle, 30 people

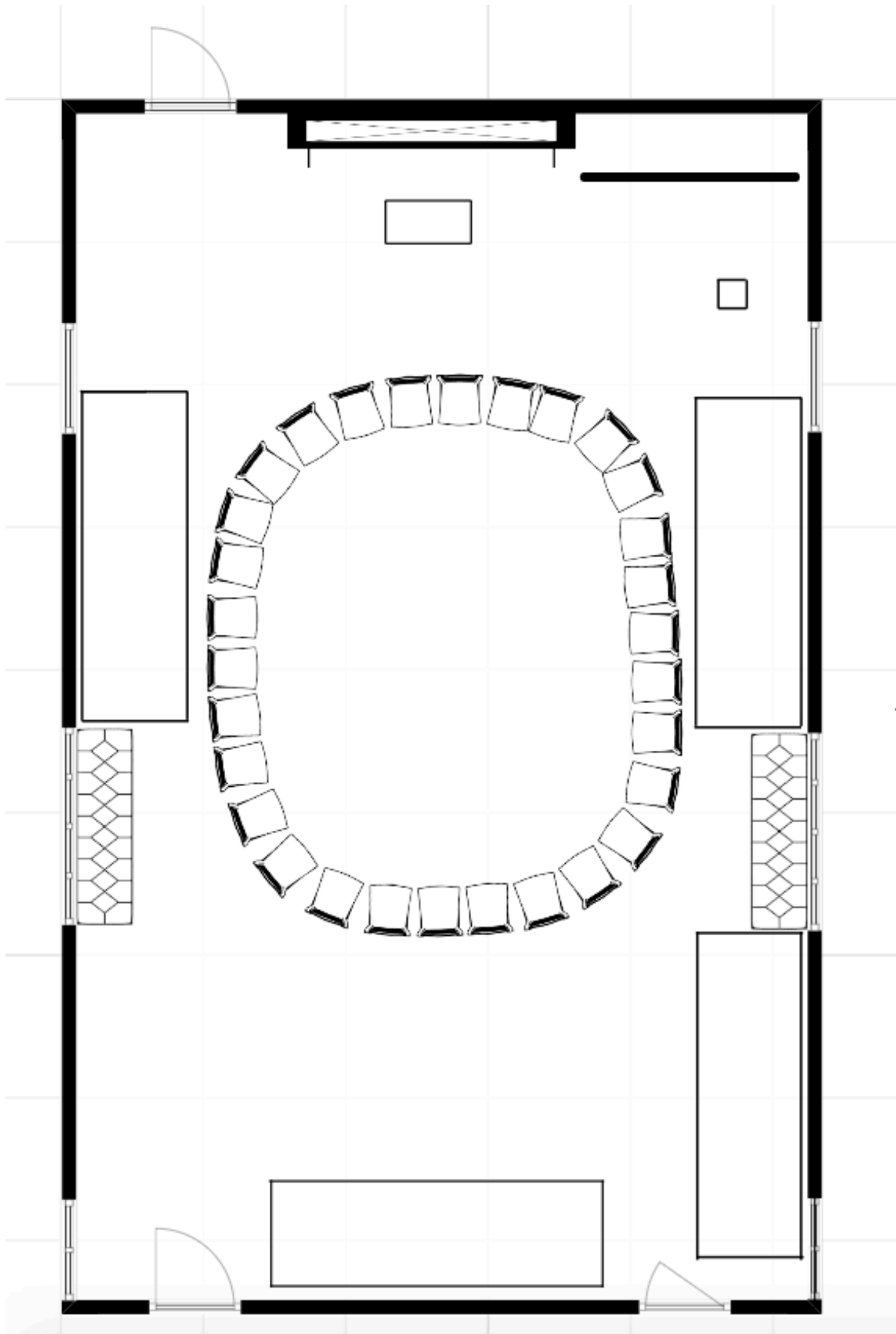

Option 6: Tables in a U-Shape, 32 people

